



Rose Bates Drive, London. NW9

£360,000
Leasehold







- EPC RATING B
- NEWLY REFURBISHED
- INVESTMENT

- COUNCIL TAX BAND C
- PARKING
- 2ND FLOOR

- 2 BEDROOMS
- GREAT LOCATION
- CHAIN FREE

A bright and spacious 2nd floor apartment situated on Rose Bates Drive, NW9.

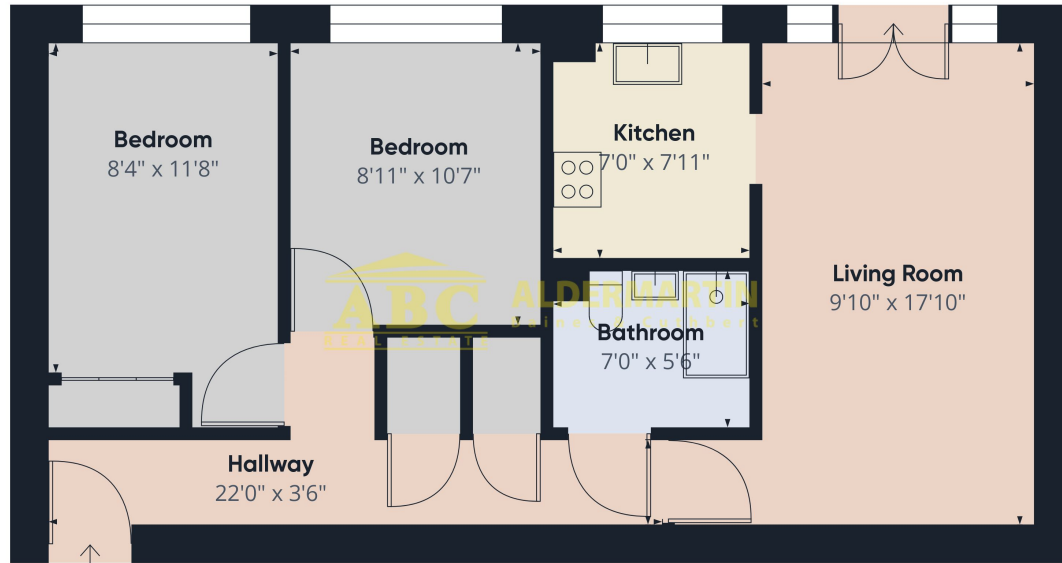

Approximate total area⁽¹⁾
602.03 ft²

(1) Excluding balconies and terraces

Comprising 2 double bedrooms, large reception room, separate modern fully fitted kitchen, family bathroom and plenty of storage space throughout.

This property is newly refurbished with fresh painting, laminate flooring, bathroom and kitchen all finished to a high standard. Any buyer would be able to move straight in or let the property right away.

Further benefits include a private balcony, off and on street parking with one allocated bay and many local amenities close by.

While every attempt has been made to ensure the information is correct, we do not warrant its accuracy. Elements are for information only. CS IPM5 3C

Energy Efficiency Rating		Current	Potential
Very energy efficient - lower running costs			
(92+)	A		
(81-91)	B	83	85
(69-80)	C		
(55-68)	D		
(39-54)	E		
(21-38)	F		
(1-20)	G		
Not energy efficient - higher running costs			
England, Scotland & Wales		EU Directive 2002/91/EC	

This property is being offer chain free with vacant possession.

EPC Rating B

Council Tax Band C

Hendon
02082 034 567
info@abcestates.co.uk

